



# SAFETY WEARABLE MANUAL

## CONTENTS

What's in the Box.....	2
Charging.....	3
Using the device .....	4
Terms & Conditions .....	6
Safety Precautions and General Warnings .....	7
Regulatory Notifications .....	8
Body-worn Operation .....	9
Specific Absorption Rate (SAR) information:.....	9

## SAFETY WEARABLE MANUAL

### WHAT'S IN THE BOX

*GEOPRO SAFETY WEARABLE DEVICE*

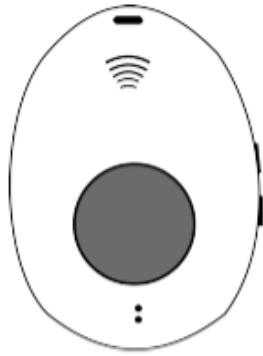

*WALL ADAPTER*

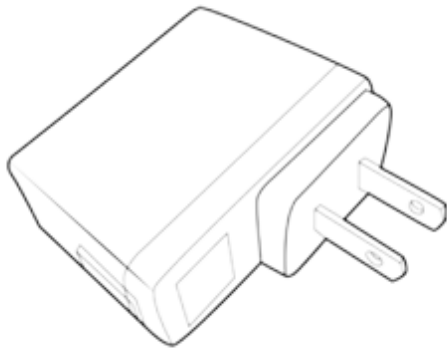

*CAR CHARGING ADAPTER*

*DESKTOP CHARGER*



*CHARGING CABLE*

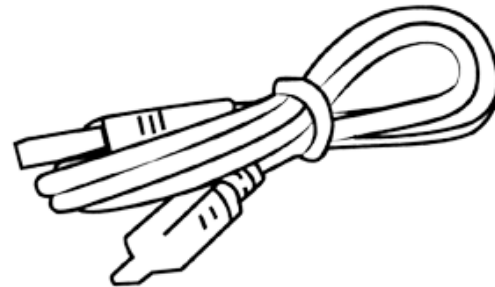

*MAGNETIC BREAKAWAY NECK LANYARD*

## SAFETY WEARABLE MANUAL



*BELT HOLSTER*

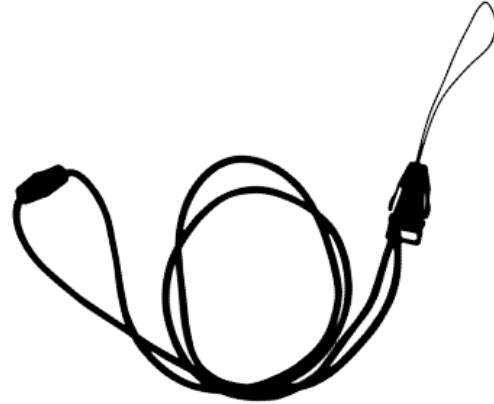

*WRIST-BAND STRAP*

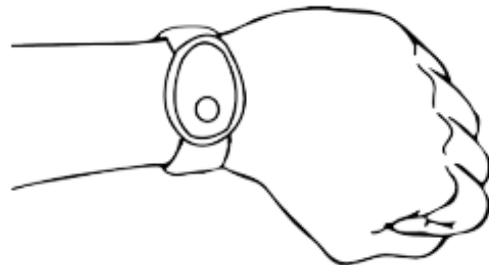
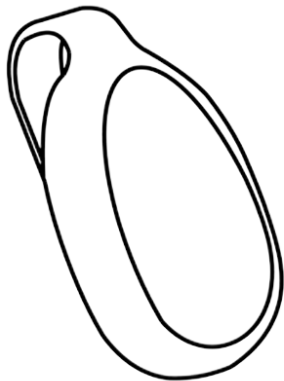

## CHARGING

1. Plug one end of the USB charging cable into the back of the AC wall adapter and the other end into the back of the desktop charger.
2. Plug the AC wall adapter into a standard power outlet.
3. Place the GeoPro Safety Wearable device into the desktop charger. You should feel a magnetic pull as you insert the device into the charger.
4. The device will illuminate Blue and flash every 5 seconds indicating the unit is charging. If the device is powered off, it will automatically power on and begin charging.
5. The device is fully charged when the Blue light stays illuminated, and no longer flashes. Battery charge takes approximately 3 hours to complete.

## SAFETY WEARABLE MANUAL

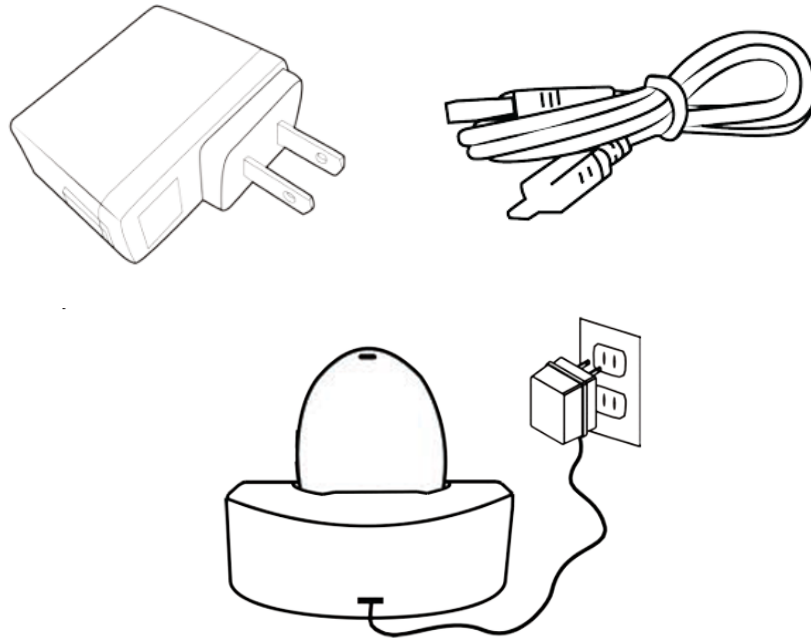

### USING THE DEVICE

#### *POWERING ON YOUR DEVICE*

To power on your device, press and hold the button for 5 seconds. The light will briefly illuminate Blue and begin to power on. The device will announce “Welcome” once it has fully powered on and registered to the cellular network. This indicates your device is ready for operation. Please ensure your GeoPro license is active before powering on, charging or begin using your device.

#### *SOS*

**IMPORTANT:** SOS service on your GeoPro device is actively monitored by the monitoring center. This feature is not to be tested unless otherwise scheduled directly with the monitoring center. Please contact Roadpost for further assistance. For optimal voice communication, it is best to hold the device approximately 10 inches in front of your mouth. You will still be able to hear the operator if worn on your arm, neck or belt.

To declare an SOS, press and hold the button for 3 seconds. Your device will begin flashing Red and announce, “Emergency countdown initiated, press and hold button to cancel emergency. Emergency will be active in 10, 9, 8, 7, 6, 5, 4, 3, 2, 1. Your emergency is now in progress”. The distress alert will be sent to the monitoring center, which will prompt them to initiate a voice call to your device. The device will automatically answer the call and will allow you to communicate the nature of your emergency to the response center.

To cancel an SOS, press and hold the button for 3 seconds. Your device will flash Green and announce, “Your emergency has been cancelled”.

#### *FALL DETECTION*



## SAFETY WEARABLE MANUAL

Fall detection is turned off by default. To enable fall detection, login to the GeoPro Web App or have a GeoPro Administrator enable the feature for your device. The sensitivity settings and cancellation timer can be set in the GeoPro Web App. Note: Upon first time use or changing sensitivity settings thereafter, the device must be laying still and flat for 30-60 seconds to calibrate the internal sensors.

When a fall has been detected, the device will illuminate Red and announce, "Fall detected, unit will send emergency alert in 30 seconds, please press button to cancel alert". Tap the button to cancel the fall detection warning if necessary. Once the countdown timer has expired, the device will flash Red and announce, "Falling has been confirmed, your emergency is in progress. Press and hold button to cancel emergency". Like SOS, the distress alert will then be sent to the monitoring center, at which point the monitoring center will place a voice call to your device.

### *TRACKING*

Sending the position reports at a regular interval is turned off by default. To enable tracking, login to the GeoPro Web App or have a GeoPro Administrator enable the feature for your device.

### *CHECKING POWER STATUS*

Checking the power status of your device will allow you to quickly assess if your device is powered on. Simply tap the button one(1) time, the device will flash Blue once and announce, "Unit is powered on" indicating the device is powered on.

### *SENDING A CHECK-IN*

Sending a check-in can be performed at any time, not only when prompted. Tap the button two(2) times to send a check-in, the device will flash Green twice and announce, "Check-In Sent".

### *STARTING A CHECK-IN SESSION*

Starting a check-in session is used to begin your check-in schedule (if assigned by your GeoPro Administrator). Tap the button three(3) times to start your check-in session. The device will flash Green three times and announce, "Check-in session started". If a check-in session has already been enabled the device will announce, "Check-in session already started". Note: If check-ins are not required, this feature can be removed. Please have your GeoPro Administrator contact Roadpost for assistance.

### *ENDING A CHECK-IN SESSION*

Ending a check-in session is used to stop your check-in schedule. Tap the button four(4) times to start your check-in session. The device will flash Green four times and announce, "Check-in session ended". If a check-in session has already been disabled the device will announce, "Check-in session already ended". You will no longer receive check-in minders once your session has been ended.

### *CHECKING BATTERY LEVEL, CELLULAR SIGNAL & WI-FI CONNECTIVITY*

Tap the button five(5) times to check the battery level, cellular signal and Wi-Fi connectivity of your device. The device will flash Blue five times and announce, "Battery level is 100%, cellular signal is very good, Wi-Fi is disconnected, check-in session is disabled" or similar. Your device will also automatically announce when the battery level has reached, 40%, 20% and 5%. Low battery updates for 20% and 5% will also be displayed in the GeoPro Web App.



## SAFETY WEARABLE MANUAL

### *POWERING OFF THE DEVICE*

Tap the button six(6) times to power off your device. The device will flash Blue six times and announce, “Unit is powering off”.

## TERMS & CONDITIONS

Installation and operation of the GeoPro Safety Wearable (iHelp+ 3G™) unit is the sole responsibility of the User. It is the User's exclusive responsibility to test all functions and ensure the equipment is in good working condition. User or purchaser is solely responsible for testing the GeoPro Safety Wearable (iHelp+ 3G™) equipment as described in the instruction manual. Wearable Health Solutions and Roadpost Inc. are not responsible for misuse or improper operation of the unit. Before using, it is required that you perform the proper tests in order to determine the unit's operation at the location(s) where it will be used. If you fail to properly test the unit, it may fail or otherwise become inoperable. In that case, the User may not receive the medical attention sought and risks serious personal injury or death.

Wearable Health Solutions and Roadpost Inc. are not responsible for the reliability or quality of the cellular phone service with which its products are used. It is the User's sole responsibility to determine where the GeoPro Safety Wearable (iHelp+ 3G™) will operate. Refer to the instruction manual for setup, operation and proper testing of the unit. It is understood by both User and Purchaser that any signals transmitted are totally beyond Wearable Health Solutions and Roadpost's control. Such telecommunication systems and equipment are not owned, operated, maintained, leased and are not controlled, inspected, or reviewed by Wearable Health Solutions and Roadpost Inc. Wearable Health Solutions and Roadpost Inc. cannot and will not be responsible for any injury, death or property damage that results from telecommunication equipment not supplied by Wearable Health Solutions or Roadpost Inc. that does not properly transmit or fails to transmit proper signals from the unit to a call center operator, a 911 center, or friends and family members as programmed by the User. Purchaser and User acknowledge that Wearable Health Solutions and Roadpost Inc. use an independent, third party call center to receive all emergency calls from the unit. Wearable Health Solutions and Roadpost Inc. are not responsible for the performance of and the response times of those operators and are not responsible for the performance of and response times of any emergency services dispatched by the independent call center, including police, fire, and medical services. User and Purchaser both understand and acknowledge that the GeoPro Safety Wearable (iHelp+ 3G™) unit requires AC power and Cellular Phone Service. Electrical outlets used to charge the GeoPro Safety Wearable (iHelp+ 3G™) cannot be on a 'hot switch' where they can be accidentally turned off. It is User's responsibility to provide electrical service in order for the GeoPro Safety Wearable (iHelp+ 3G™) to fully charge in order to function.

Wearable Health Solutions and Roadpost Inc. neither warrants nor represents that the GeoPro Safety Wearable (iHelp+ 3G™) will prevent any damage, injury, or loss to either person or property, or that the GeoPro Safety Wearable (iHelp+ 3G™) unit will always provide the full protection for which it is intended. Both the Purchaser and User fully understand and acknowledge that Wearable Health Solutions and Roadpost Inc. are not insurers, and that User and Purchaser assumes any and all risk of loss or injury to User's property or person. No representation or warranties express or implied are made by Wearable Health Solutions other than those expressed herein, and Wearable Health Solutions and Roadpost Inc. expressly disclaims any warranty of fitness or merchant ability for any particular use.



## SAFETY WEARABLE MANUAL

After the laboratory measurement, this phone max SAR value is 1.27W/kg. GeoPro Safety Wearable (iHelp+ 3G™) device complies with the limits for a Class B digital device, pursuant to Part 15 of the FCC Rules.

These limits are designed to provide reasonable protection against harmful interference in a residential installation. Operation is subject to these conditions:

(1) This device may not cause harmful interference, and

(2) This device must accept any interference received, including interference that may cause undesired operation. The manufacturers not responsible for any radio or TV interference caused by unauthorized modifications to this equipment. Such modifications could void the user's authority to operate the equipment. This product generates, uses, and can radiate radio frequency energy and, if not installed and used in accordance with the instructions, may cause harmful interference to radio communications. However, there is no guarantee that interference will not occur in a particular installation. If this product does cause harmful interference to radio or television reception, the user is encouraged to try to correct the interference by one or more of the following measures:

- Reorient or relocate the receiving antenna.
- Increase the separation between the equipment and receiver.
- Connect your equipment into an outlet on a circuit different from that to which the receiver is connected.
- Consult the dealer or an experienced radio/TV technician for help.

3. Roadpost Inc. warrants this product and all parts, thereof, only to the original purchaser to be free from defective materials and workmanship from the date of the original purchase for the period of one (1) year. If your product is found to be defective within the warranty period,

Roadpost will repair or replace defective parts with new or rebuilt equivalents at no charge to the original owner. Parts used for replacement are warranted only for the remainder of the Warranty Period. If your product is found to be defective, please contact the dealer you purchased your product from for warranty repair instructions.

## SAFETY PRECAUTIONS AND GENERAL WARNINGS

A minimum separation of six (6) inches should be maintained between a handheld wireless mobile device and an implantable medical device to avoid potential interference with the device. Persons who have such devices:

- Should ALWAYS keep the mobile device more than six (6) inches from their implantable medical device when the mobile device is turned ON.
- Should not carry the mobile device in a breast pocket.
- Should use the ear opposite the implantable medical device to minimize the potential for interference.
- Should read and follow the directions from the manufacturer of your implantable medical device.

If you have any questions about using your wireless mobile device with an implantable medical device, consult your health care provider. It is the sole responsibility of the User to charge the GeoPro Safety Wearable (iHelp+ 3G™) when necessary to ensure that the batteries and other functions/ features are working properly. See the Instructions for how to perform these tests. It is advised to charge the GeoPro Safety Wearable (iHelp+ 3G™) daily until fully charged.



## SAFETY WEARABLE MANUAL

Wearable Health Solutions represents that the GeoPro Safety Wearable (iHelp+ 3G™) unit is waterproof with an IPX7\* rating.

\*IPX7 rating states product is protected against high pressure water jets from any direction. Limited ingress permitted (ex. shower). Protected against short periods of immersion for 30 minutes (- ex. bath).

Based on its operating frequency, GeoPro Safety Wearable (iHelp+ 3G™) should not interfere with pacemakers or common household appliances. No other power source may be used for this product other than the one specifically supplied by Wearable Health Solutions. Use of any other power source will void all warranties and could also damage your unit and cause serious safety issues including personal injury, property damage, and cause the unit to malfunction resulting in the failure to obtain medical attention.

The GeoPro Safety Wearable (iHelp+ 3G™) should be unplugged from an electrical outlet before attempting to clean it. A damp, soft cloth can be used to clean/wipe down the unit if it becomes dirty. No liquids or cleaners can be used for cleaning or the warranty will be voided.

If damage does occur to your unit, do not attempt to repair it. Please return the entire unit, postage paid, to your local dealer for warranty service or replacement as stipulated in the warranty section of this manual.

Please use a lanyard with a break-away cord, like the one supplied with your GeoPro Safety Wearable (iHelp+ 3G™) unit. By using a lanyard that doesn't have a break-away cord, you run the risk of choking, including the possibility of serious injury. The lanyard can get entangled on machinery, equipment, jewelry, clothes, or other objects that could entangle with a neck cord.

## REGULATORY NOTIFICATIONS

IC ID: 8730A-PD

Le present appareil est conforme aux CNR d'Industrie Canada applicables aux appareils radio exempts de licence.

L'exploitation est autorisée aux deux conditions suivantes : (1) l'appareil ne doit pas produire de brouillage (2) l'utilisateur de l'appareil doit accepter tout brouillage radio électriques, même si le brouillage est susceptible d'encompromettre le fonctionnement.

This device complies with Industry Canada's licence-exempt RSSs.

Operation is subject to the following two conditions:

- (1) This device may not cause interference; and
- (2) This device must accept any interference, including interference that may cause undesired operation of the device.

This device complies with Part 15 of the FCC Rules. Operation is subject to the following two conditions:

- (1) This device may not cause harmful interference.





## SAFETY WEARABLE MANUAL

(2) This device must accept any interference received, including Interference that may cause undesired operation.

FCC ID: XWI-CS399

NOTE: Changes or modifications not expressly approved by the party responsible for compliance could void the user's authority to operate the equipment.

NOTE: This equipment has been tested and found to comply with the limits for a Class B digital device, pursuant to Part 15 of the FCC Rules. These limits are designed to provide reasonable protection against harmful interference in a residential installation. This equipment generates uses and can radiate radio frequency energy and, if not installed and used in accordance with the instructions, may cause harmful interference to radio communications. However, there is no guarantee that interference will not occur in a particular installation.

If this equipment does cause harmful interference to radio or television reception, which can be determined by turning the equipment off and on, the user is encouraged to try to correct the interference by one or more of the following measures:

---Reorient or relocate the receiving antenna.

---Increase the separation between the equipment and receiver.

---Connect the equipment into an outlet on a circuit different from that to which the receiver is connected.

---Consult the dealer or an experienced radio/TV technician for help.

### BODY-WORN OPERATION

This device was tested for typical body-worn operations. To comply with RF exposure requirements, a minimum separation distance of 2.0 cm must be maintained between the user's body and the handset, including the antenna. Third-party belt-clips, holsters, and similar accessories used by this device should not contain any metallic components. Body-worn accessories that do not meet these requirements may not comply with RF exposure requirements and should be avoided.

### SPECIFIC ABSORPTION RATE (SAR) INFORMATION:

Systems operating under the provisions of this section shall be operated in a manner that ensures that the public is not exposed to radio frequency energy level in excess limit for maximum permissible exposure. In accordance with 47 CFR FCC Part 2 Subpart J, section 2.1091 this device has been defined as a mobile device whereby a distance of 0.2m normally can be maintained between the user and the device.

NOTE: Operating temperature ranges -4 Fahrenheit ~ 140 Fahrenheit